

# MRM Stationary Medium-Expansion Foam Generator

## Description

The SKUM MRM is a medium-expansion foam generator, designed for fixed installation. It converts foam liquid and water solutions into medium-expansion foam. The MRM Stationary Medium-Expansion Foam Generator is installed as part of a fire protection system that could use one or more MRM foam generators.

## Application

The SKUM MRM Stationary Medium-Expansion Foam Generator is designed for land based applications. It is designed to protect flammable liquid spillage areas and locations that require a layer of medium-expansion foam, such as the following examples:

- Bunded areas
- Under dock protection
- Spill fires
- Basins and loading facilities

## Features

- Stainless steel body
- Hot-dipped slip-on galvanized flange and brass nozzle
- Trouble-free installation
- Large area coverage
- Suitable for indoor and outdoor use
- Capacity up to 2,000 Lpm

## Connections

- Flanged to fit DIN PN16 or ANSI B 150 lb

Figure 1: MRM dimensions

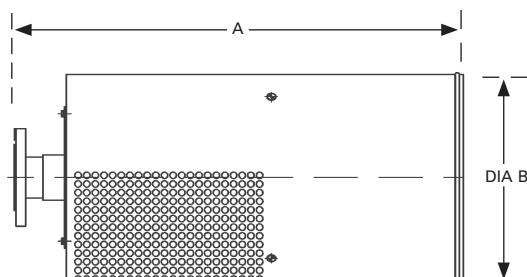

Note: For the MRM dimensions, see Table 2.



E002266

## Ordering information

When ordering, specify the following information:

- Part number (see Table 1)
- Size
- Connection: DIN or ANSI
- Capacity

Table 1: Part numbers

| Part No.  | Description         |
|-----------|---------------------|
| 102105114 | MRM-50 DIN 200 Lpm  |
| 102105212 | MRM-50 DIN 400 Lpm  |
| 102105163 | MRM-50 ANSI 200 Lpm |
| 102105261 | MRM-50 ANSI 400 Lpm |
| 102106110 | MRM-65 DIN          |
| 102106215 | MRM-65 ANSI         |
| 102108112 | MRM-80 DIN          |
| 102108217 | MRM-80 ANSI         |

## Performance data

**Table 2: Performance data**

| <b>MRM model:</b>                        | <b>50F to 200</b>                 |         | <b>50F to 400</b>                 |         | <b>65F</b>                        |         | <b>80F</b>                        |           |
|--|-----------------------------------|---------|-----------------------------------|---------|-----------------------------------|---------|-----------------------------------|-----------|
| <b>Inlet pressure:</b>                   | 3 bar                             | 5 bar   | 3 bar                             | 5 bar   | 3 bar                             | 5 bar   | 3 bar                             | 5 bar     |
| <b>Water capacity:</b>                   | 155 Lpm                           | 200 Lpm | 310 Lpm                           | 400 Lpm | 620 Lpm                           | 800 Lpm | 1,550 Lpm                         | 2,000 Lpm |
| <b>k-factor:</b>                         | 89                                |         | 178                               |         | 358                               |         | 895                               |           |
| <b>Approximate foam expansion ratio:</b> | 40:1                              |         | 40:1                              |         | 40:1                              |         | 40:1                              |           |
| <b>Dimensions A:</b>                     | 710 mm                            |         | 710 mm                            |         | 830 mm                            |         | 850 mm                            |           |
| <b>Dimensions B:</b>                     | 240 mm                            |         | 240 mm                            |         | 380 mm                            |         | 380 mm                            |           |
| <b>Connection:</b>                       | 50 DIN PN 16 or 2 in. ANSI 150 lb |         | 50 DIN PN 16 or 2 in. ANSI 150 lb |         | 65 DIN PN 16 or 2 1/2 ANSI 150 lb |         | 80 DIN PN 16 or 3 in. ANSI 150 lb |           |
| <b>Weight:</b>                           | 10 kg                             |         | 10 kg                             |         | 15 kg                             |         | 15 kg                             |           |
| <b>Range of jet:</b>                     | 3 m to 5 m                        |         | 3 m to 5 m                        |         | 3 m to 5 m                        |         | 3 m to 5 m                        |           |
| <b>Body material:</b>                    | Stainless steel                   |         | Stainless steel                   |         | Stainless steel                   |         | Stainless steel                   |           |
| <b>Nozzle material:</b>                  | Brass                             |         | Brass                             |         | Brass                             |         | Brass                             |           |
| <b>Range material:</b>                   | Galvanized steel                  |         | Galvanized steel                  |         | Galvanized steel                  |         | Galvanized steel                  |           |

**Note:** The foam expansion ratio depends on the foam concentrate type.

Safety Data Sheets (SDS) are available at [www.skum.com](http://www.skum.com)

**Note:** The converted values in this document are provided for dimensional reference only and do not reflect an actual measurement.

SKUM, and the product names listed in this material are marks and/or registered marks. Unauthorized use is strictly prohibited.