

PFG and PFG-S High Back Pressure Foam Generators

Description

The PFG and PFG-S High Back Pressure Foam Generators are a range of foam making units that produce expanded foam by introducing air into a water and foam liquid solution. The PFG-S version has a built-in foam liquid inductor.

Application

Foam makers are primarily used for subsurface and semi-subsurface foam systems on flammable liquid storage tanks. Other applications include foam inlet heads and pourers at tank tops where aerated foam requires distribution through a pipeline.

PFG features

- High back pressure, up to 40% of inlet pressure
- Factory calibrated to customer requirements
- Vertical or horizontal installation

PFG-S additional features

- Built-in foam inductor
- Suction height up to 2.5 m
- Capable of withstanding counter-pressures up to 40% of the inlet pressure

Connections

- Water inlet: flanged to fit DIN PN16 or ANSI 150 lbs
- Foam inlet on PFG-S screw threaded BSP

Optional components

- Foam inlet check valve screw threaded BSP female or hose tail connection
- A range of flanges are available - contact Johnson Controls Technical Services
- Units available in other materials on request

Listings and approvals

- KFSD (Kuwait)

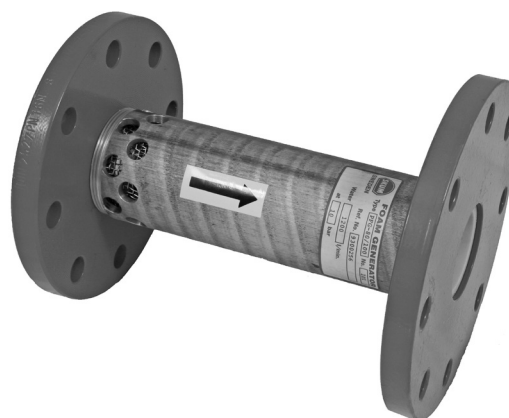

E000086

Ordering information

Specify the following when ordering:

- Part number
- Capacity: flow and pressure
- Foam induction (S-version)

Table 1: Part numbers

Part No.	Description
144005107	PFG - 50/80 DIN
144005204	PFG - 50/80 ANS
144008109	PFG - 80/100 DIN
144008206	PFG - 80/100 ANS
144010103	PFG - 100/150 DIN
144010203	PFG - 100/150 ANS
PFG-S Part No.	
144005508	PFG - 50/80 S DIN
144005609	PFG - 50/80 S ANS
144008504	PFG - 80/100 S DIN
144008607	PFG - 80/100 S ANS
144010505	PFG - 100/150 S DIN
144010607	PFG - 100/150 S ANS

Note: The converted values in this document are provided for dimensional reference only and do not reflect an actual measurement. SKUM and the product names listed in this material are marks and/or registered marks. Unauthorized use is strictly prohibited.

Specifications

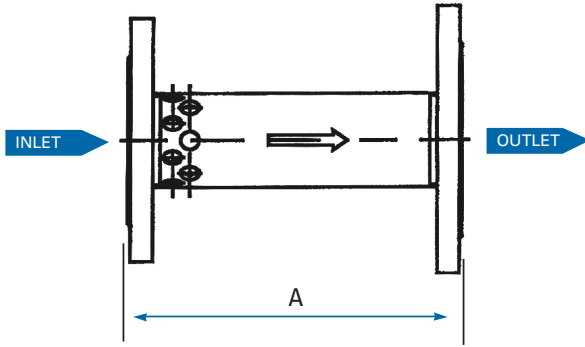

FIGURE 1
PFG FOAM
GENERATOR

Note: For dimensions A, B and C, see Table 2.

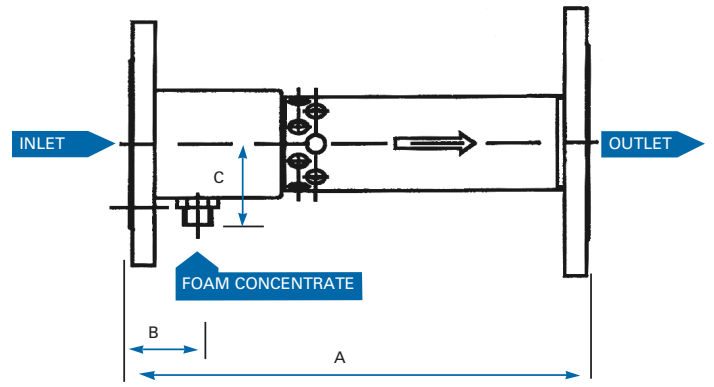

FIGURE 2
PFG-S FOAM
GENERATOR

Table 2: Specifications

PFG and PFG-S Generators	50/80	50/80 S	80/100	80/100 S	100/150	100/150 S
Solution capacity	100 Lpm to 750 Lpm (27 gpm to 198 gpm)		750 Lpm to 1,400 Lpm (198 gpm to 370 gpm)		1,400 Lpm to 2,400 Lpm (370 gpm to 634 gpm)	
Dimensions A	208 mm	275 mm	278 mm	355 mm	352 mm	475 mm
Dimensions B		40 mm		60 mm		69 mm
Dimensions C		42 mm		52 mm		63 mm
Inlet connection	50 DIN PN 16 or 2 in. ANSI 150 lb		80 DIN PN 16 or 3 in. ANSI 150 lb		100 DIN PN 16 or 4 in. ANSI 150 lb	
Outlet connection	80 DIN PN 16 or 3 in. ANSI 150 lb		100 DIN PN 16 or 4 in. ANSI 150 lb		150 DIN PN 16 or 6 in. ANSI 150 lb	
Foam concentrate connection		Male 3/4 in. BSP		Male 1 in. BSP		Male 1 in. BSP
Foam concentrate induction		Max 6%		Max 6%		Max 6%
Foam expansion ratio*	Approximately 10:1		Approximately 10:1		Approximately 10:1	
Maximum counter pressure	40% of inlet pressure		40% of inlet pressure		40% of inlet pressure	
Working pressure range	6 bar to 16 bar (87 psi to 232 psi)		6 bar to 16 bar (87 psi to 232 psi)		6 bar to 16 bar (87 psi to 232 ppsi)	
Material: body	Bronze					
Material: nozzle / diffuser	Polypropylene					
Material: flange	Primer and red 2-component painted steel					
Weight	10 kg (22 lb)	11 kg (24 lb)	14 kg (31 lb)	16 kg (35 lb)	22 kg (49 lb)	25 kg (55 lb)

*Depending on foam concentrate type

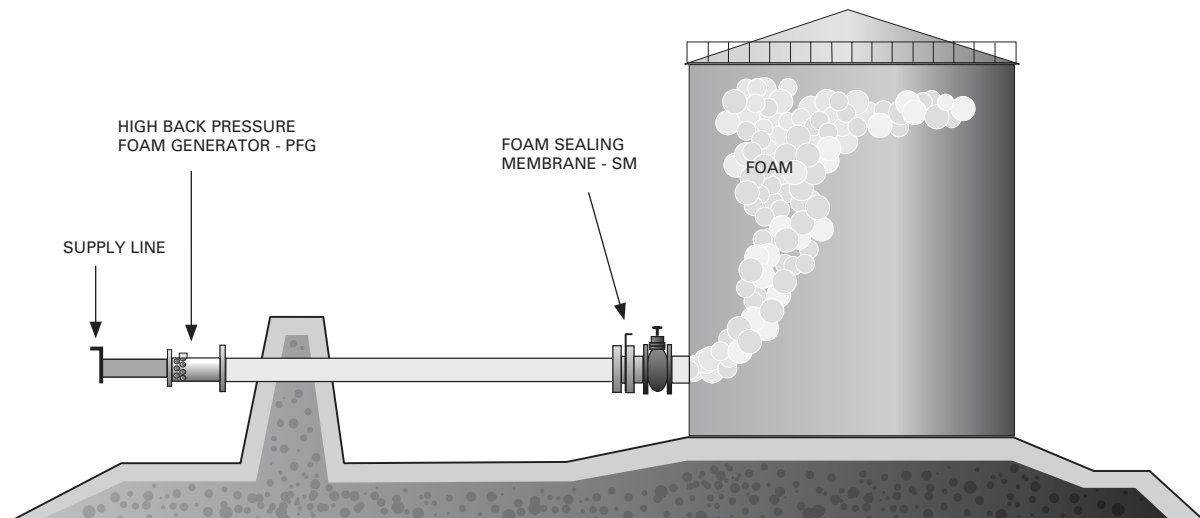

FIGURE 3
SYSTEM IN OPERATION